

BEAM SCHEDULE

- B1 HEADERS & BEAMS 6x10 DF1 OR AS NOTED
- B2 BEAMS AT PORCH AND PATIO AREAS: 4x12 DF1 OR AS NOTED, BEARING ON MIN (2) 2x4 STUDS OR 4x4 POST FRAMED INTO WALL.

REFER TO PRE-ENGINEER TRUSS ENGINEERING AND COMPLETE PROFILES OF

EXAMPLE OF PRE-APPROVED PLANS. PLANS AVAILABLE FOR 498, 749, OR 1,190 SF. LAYOUTS IN THREE ARCHITECTURAL STYLES THROUGH THE CITY OF MERCED PRE-APPROVED ADU PROGRAM. CONTACT INSPECTION SERVICES DIVISION AT (209) 385-4773 OR INSPECTIONSERVICESWEB@CITYOFMERCED.ORG FOR MORE INFORMATION.

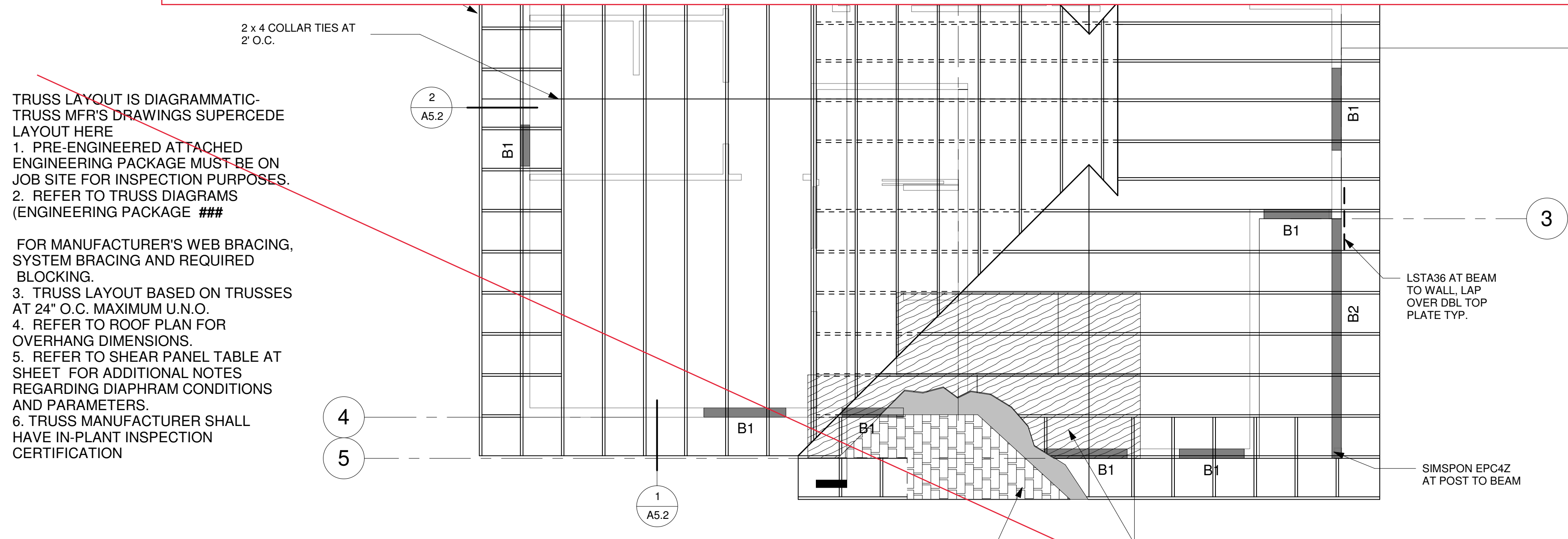

TRUSS LAYOUT IS DIAGRAMMATIC- TRUSS MFR'S DRAWINGS SUPERCEDE LAYOUT HERE

1. PRE-ENGINEERED ATTACHED ENGINEERING PACKAGE MUST BE ON JOB SITE FOR INSPECTION PURPOSES.
2. REFER TO TRUSS DIAGRAMS (ENGINEERING PACKAGE ###)
- FOR MANUFACTURER'S WEB BRACING, SYSTEM BRACING AND REQUIRED BLOCKING.
3. TRUSS LAYOUT BASED ON TRUSSES AT 24" O.C. MAXIMUM U.N.O.
4. REFER TO ROOF PLAN FOR OVERHANG DIMENSIONS.
5. REFER TO SHEAR PANEL TABLE AT SHEET FOR ADDITIONAL NOTES REGARDING DIAPHRAM CONDITIONS AND PARAMETERS.
6. TRUSS MANUFACTURER SHALL HAVE IN-PLANT INSPECTION CERTIFICATION

COMPOSITION SHINGLES OVER 2 LAYERS 30# FELT. PROVIDE FLASHING AT VALLEYS. CHANGES IN ROOF DIRECTION, AT ROOF TOP OBSTACLES PREVENTING POSITIVE RUN-OFF, NO 26 GA MINIMUM. VERIFY WARRANTY, STYLE AND COLOR, FLASHING GAUGE AND MATERIAL AND COLOR, EAVE AND RAKE DRIP EDGE GAUGE AND MATERIAL AND COLOR WITH OWNER PRIOR TO BID.

TYPICAL ROOF SHEATHING: PROVIDE 1/2" C.D.X. OR O.S.B., UNBLOCKED PLYWOOD SHEATHING NAILED W/ 8d @ 6" O.C. @ EDGE, 8" O.C. FIELD. *GAP 1/8" AT ALL EDGES. MAXIMUM SIZE OF OPENINGS IN HORIZONTAL DIAPHRAGMS ARE NOT TO EXCEED 24" WITHOUT BLOCKING. INDIVIDUAL SHEETS USED IN THE CONSTRUCTION OF DIAPHRAGMS SHALL BE NOT LESS THAN 4' x 8'. REFER TO DETAIL B/A5.2 FOR ADDITIONAL PARAMETERS AND MINIMUM CONDITIONS

ATTIC VENTILATION: VENTILATION METHOD: 50% HIGH, 50% LOW (Cite R806.2 exception 2).
 Math: $[(1246.4 * (1/300)) * 144] / 2 = 299.1$ sq in high, 299.1 sq in low.
 Use O'HAGIN'S TAPERED, LOW-PROFILE VENT (STANDARD FLANGE) = 72 sq in NVFA
 $299.1 \text{ sq in} / 72 = 4.15$; USE 4 VENT(S) LOW, 4 VENT(S) HIGH

EXCERPT FROM CRC R806.1
 Enclosed attics and enclosed rafter spaces formed where ceilings are applied directly to the underside of roof rafters shall have cross ventilation for each separate space by ventilating openings protected against the entrance of rain or snow. Ventilating openings shall have least dimension of 1/16 inch (1.6 mm) minimum and 1/4 inch (6.4 mm) maximum. Ventilating openings having a least dimension larger than 1/4 inch (6.4 mm) shall be provided with corrosion-resistant wire cloth screening, hardware cloth, or similar material with openings having a least dimension of 1/16 inch (1.6 mm) minimum and 1/4 inch (6.4 mm) maximum.

EXCERPT FROM CRC R806.2
 Minimum vent area. The minimum net free ventilating area shall be 1/150 of the area of the vented space.
 Exception: The minimum net free ventilating area shall be 1/300 of the vented space provided one or more of the following conditions are met:
 1. In Climate Zones 14 and 16, a Class I or II vapor retarder is installed on the warm-in-winter side of the ceiling.
 2. Not less than 40 percent and not more than 50 percent of the required ventilating area is provided by ventilators located in the upper portion of the attic or rafter space. Upper ventilators shall be located not more than 3 feet (914 mm) below the ridge or highest point of the space, measured vertically, with the balance of the required ventilation provided by eave or cornice vents. Where the location of wall or roof framing members conflicts with the installation of upper ventilators, installation more than 3 feet (914 mm) below the ridge or highest point of the space shall be permitted.

EXCERPT FROM CRC R303.5.1
 Intake openings. Mechanical and gravity out-door air intake openings shall be located not less than 10 feet (3048 mm) from any hazardous or noxious contaminant, such as vents, chimneys, plumbing vents, streets, alleys, parking lots and loading docks. For the purpose of this section, the exhaust from dwelling unit toilet rooms, bathrooms and kitchens shall not be considered as hazardous or noxious.
 Exceptions: 1. The 10-foot (3048 mm) separation is not required where the intake opening is located 3 feet (914 mm) or greater below the contaminant source.
 2. Vents and chimneys serving fuel-burning appliances shall be terminated in accordance with the applicable provisions of Chapters 8.
 3. Clothes dryer exhaust ducts shall be terminated in accordance with Section CMC 502.2.1.

2 ROOF FRAMING PLAN
1/4" = 1'-0"

3 ROOF PLAN
1/8" = 1'-0"

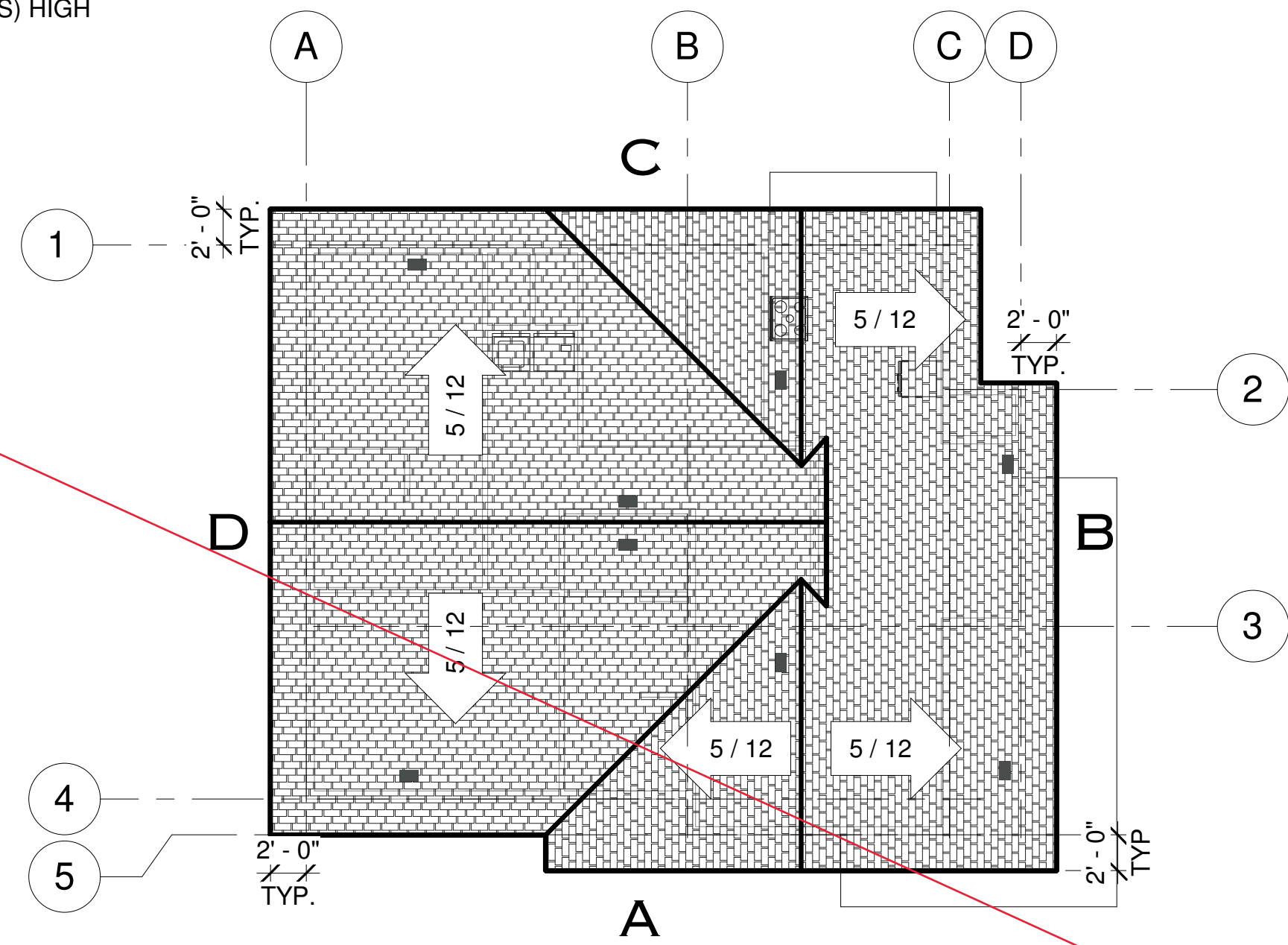

ROOF FRAMING PLAN / ROOF PLAN

CITY OF MERCED ACCESSORY DWELLING UNIT PROGRAM

1190
RESEDA

No.	Description	DATE
A	SITE PLAN REVIEW	5/11/2022
B	SITE PLAN REVIEW	6/13/2022
C	DRAFT RELEASE	8/31/2022
D	DRAFT RELEASE	9/29/2022
1		
2		
3		

Project Number
2210.2

S1.2
set date: 9/29/2022