



## CHECKLIST FOR COMMERCIAL ELECTRICAL VEHICLE CHARGING STATIONS

All forms available at

[https://www.cityofmerced.org/depts/cd/building/electronic\\_plan\\_review/default.asp](https://www.cityofmerced.org/depts/cd/building/electronic_plan_review/default.asp)

All plans shall be submitted to:

<https://merced.seamlessdocs.com/f/LFTInspectionServicesWeb>

- Completed Building permit application
- Site plan
- Electrical plan
- Equipment Manufacturer's Installation Instructions

### PLAN REQUIREMENTS:

#### Site Plan:

- Building footprints and landscaped areas
- Parking and circulation areas
- Show locations of any existing and all proposed EV stations, panels, and other service equipment
- Demonstrate compliance with accessibility provisions

#### Electrical Plan:

- Electrical and equipment layout
- Single line diagram
- Electrical Load Calculations (Existing + New) and Panel schedule
- Demonstrate compliance with accessibility provisions

Considerations made for (a) through (d)

- (a) Electric vehicle charging station equipment shall meet the requirements of the California Electrical Code, the Society of Automotive Engineers, the National Electrical Manufacturers Association, and accredited testing laboratories such as Underwriters Laboratories, and rules of the Public Utilities Commission or a Municipal Electric Utility Company regarding safety and reliability.
- (b) Installation of electric vehicle charging stations and associated wiring, bonding, disconnecting means and overcurrent protective devices shall meet the requirements of Article 625 and all applicable provisions of the California Electrical Code.
- (c) Installation of electric vehicle charging stations shall be incorporated into the load calculations of all new or existing electrical services and shall meet the requirements of the California Electrical Code. Electric vehicle charging equipment shall be considered a continuous load.
- (d) Anchorage of either floor-mounted or wall-mounted electric vehicle charging stations shall meet the requirements of the California Building or Residential Code as applicable per occupancy, and the provisions of the manufacturer's installation instructions. Mounting of charging stations shall not adversely affect building elements.

Total Number Of EVCS At Facility	Minimum Number (by type) Of EVCS Required		
	Van Accessible	Standard Accessible	Ambulatory
1-4	1	0	0
5-25	1	1	0
26-50	1	1	1
>50	See CBC Table 11B-228.3.2.1		

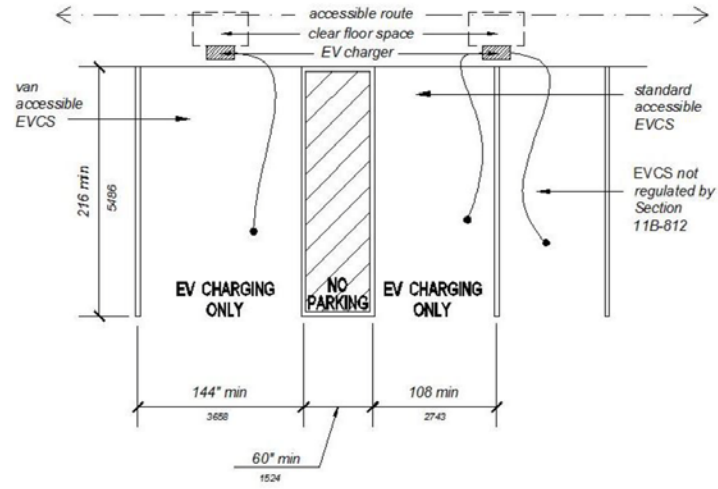

FIGURE 11B-812.9.  
SURFACE MARKING